

Neighbour Notification Plan

Development Application: Proposed Public Artwork - *Monuments for Fishes*

Location: Watermans Cove, Barangaroo South, Darling Harbour Waterway

Address: Barangaroo Avenue, Barangaroo NSW 2000

Applicant: Lendlease (Millers Point) Pty Ltd

Artist: Mikala Dwyer

Engineer: Event Engineering

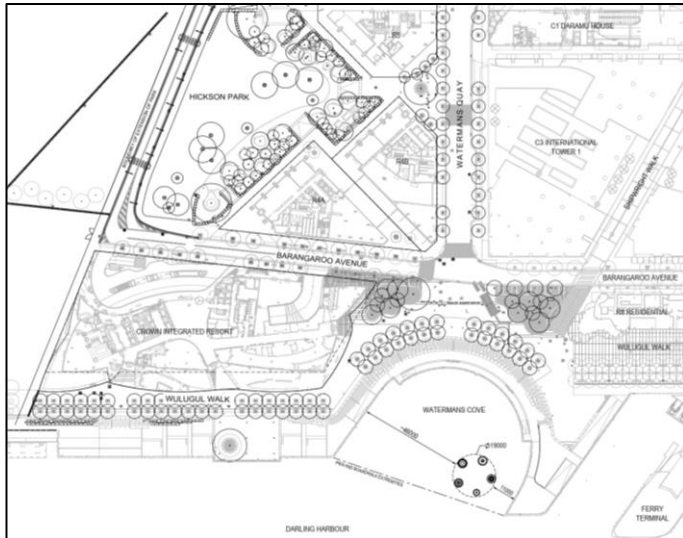

Site Plan

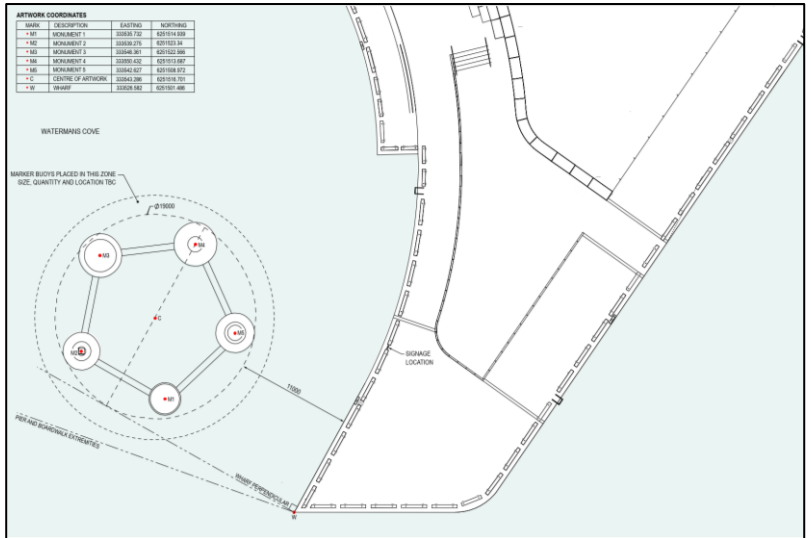

Pier Plan View

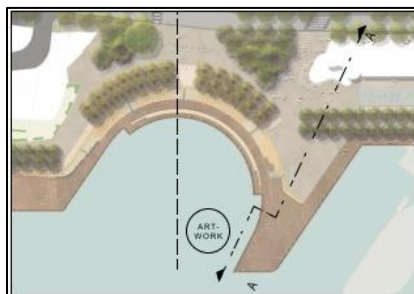

KEY PLAN

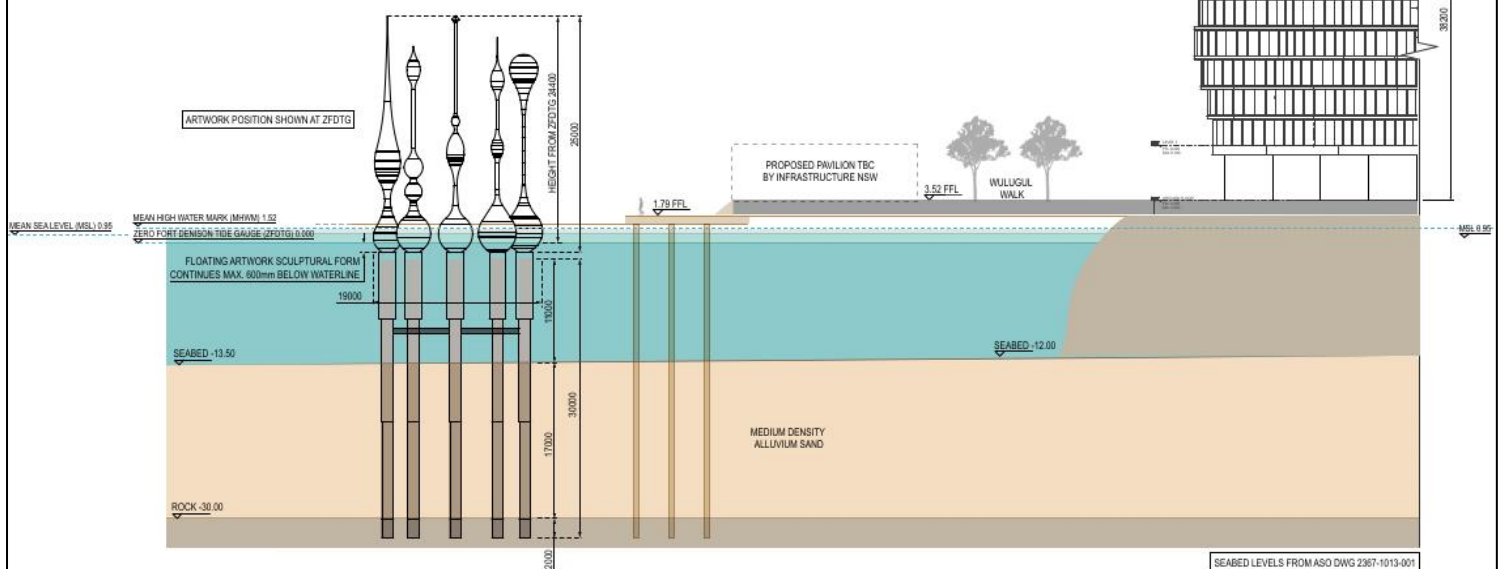

Section Plan

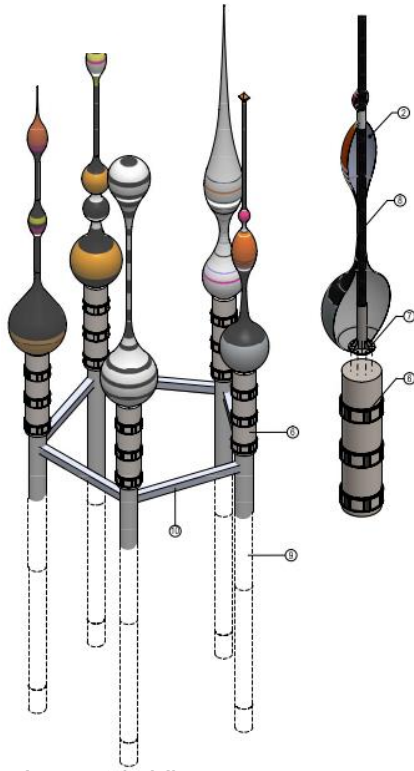

Isometric View

ITEM NO.	DESCRIPTION	QTY.
1	MONUMENT 1	1
2	MONUMENT 2	1
3	MONUMENT 3	1
4	MONUMENT 4	1
5	MONUMENT 5	1
6	KEEL	5
7	MAST BASE	5
8	MAST (x 3 SECTIONS)	5
9	PIER	5
10	RING BEAM	1

Key

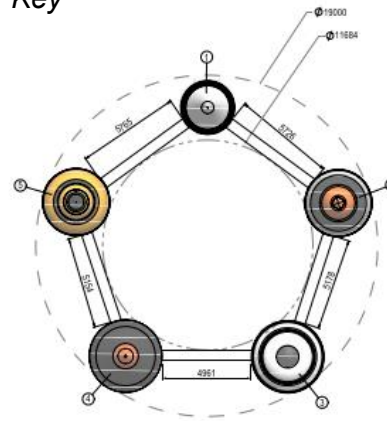

Plan View



Artist impression only. Design subject to change. View lines and fixtures may differ from that shown.

Render view from Waterman's Cove



Artist impression only. Design subject to change. View lines and fixtures may differ from that shown.

Render view to Waterman's Cove